

Vendor Statement

The vendor makes this statement in respect of the land in accordance with section 32 of the *Sale of Land Act 1962*.

This statement must be signed by the vendor and given to the purchaser before the purchaser signs the contract.

The vendor may sign by electronic signature.

The purchaser acknowledges being given this statement signed by the vendor with the attached documents before the purchaser signed any contract.

Land

21 Williams Street, Ouyen 3490

Vendor's name

Visann Properties Pty Ltd (ACN 630 652 179)

Date

17/02/2020

Vendor's signature

Vincent A. Visann

Director/Secretary

Purchaser's name

Date

/ /

Purchaser's signature

Purchaser's name

Date

/ /

Purchaser's signature

1. FINANCIAL MATTERS

1.1 Particulars of any Rates, Taxes, Charges or Other Similar Outgoings (and any interest on them)

(a) Are contained in the attached certificate/s.

1.2 Particulars of any Charge (whether registered or not) imposed by or under any Act to secure an amount due under that Act, including the amount owing under the charge

	To	
--	----	--

Other particulars (including dates and times of payments):

1.3 Terms Contract

This section 1.3 only applies if this vendor statement is in respect of a terms contract where the purchaser is obliged to make 2 or more payments (other than a deposit or final payment) to the vendor after the execution of the contract and before the purchaser is entitled to a conveyance or transfer of the land.

Not Applicable.

1.4 Sale Subject to Mortgage

This section 1.4 only applies if this vendor statement is in respect of a contract which provides that any mortgage (whether registered or unregistered), is NOT to be discharged before the purchaser becomes entitled to possession or receipts of rents and profits.

Not Applicable.

2. INSURANCE

2.1 Damage and Destruction

This section 2.1 only applies if this vendor statement is in respect of a contract which does NOT provide for the land to remain at the risk of the vendor until the purchaser becomes entitled to possession or receipt of rents and profits.

Not Applicable.

2.2 Owner Builder

This section 2.2 only applies where there is a residence on the land that was constructed by an owner-builder within the preceding 6 years and section 137B of the *Building Act* 1993 applies to the residence.

Not Applicable.

3. LAND USE

3.1 Easements, Covenants or Other Similar Restrictions

(9) A description of any easement, covenant or other similar restriction affecting the land (whether registered or unregistered): -

Not Applicable.

3.2 Road Access

There is NO access to the property by road if the square box is marked with an 'X'

3.3 Designated Bushfire Prone Area

The land is in a designated bushfire prone area under section 192A of the *Building Act* 1993 if the square box is marked with an 'X'

3.4 Planning Scheme

Attached is a certificate with the required specified information.

4. NOTICES

4.1 Notice, Order, Declaration, Report or Recommendation

Particulars of any notice, order, declaration, report or recommendation of a public authority or government department or approved proposal directly and currently affecting the land, being a notice, order, declaration, report, recommendation or approved proposal of which the vendor might reasonably be expected to have knowledge:

Not Applicable.

4.2 Agricultural Chemicals

There are NO notices, property management plans, reports or orders in respect of the land issued by a government department or public authority in relation to livestock disease or contamination by agricultural chemicals affecting the ongoing use of the land for agricultural purposes. However, if this is not the case, the details of any such notices, property management plans, reports or orders, are as follows:

Nil.

4.3 Compulsory Acquisition

The particulars of any notices of intention to acquire that have been served under section 6 of the *Land Acquisition and Compensation Act 1986* are as follows:

Nil.

5. BUILDING PERMITS

Particulars of any building permit issued under the *Building Act 1993* in the preceding 7 years (required only where there is a residence on the land):

Not Applicable.

6. OWNERS CORPORATION

This section 6 only applies if the land is affected by an owners corporation within the meaning of the *Owners Corporations Act 2006*.

Not Applicable.

7. GROWTH AREAS INFRASTRUCTURE CONTRIBUTION ("GAIC")

Not applicable.

8. SERVICES

The services which are marked with an 'X' in the accompanying square box are NOT connected to the land:

Electricity supply <input type="checkbox"/>	Gas supply <input type="checkbox"/>	Water supply <input type="checkbox"/>	Sewerage <input type="checkbox"/>	Telephone services <input checked="" type="checkbox"/>
---	-------------------------------------	---------------------------------------	-----------------------------------	--

9. TITLE

Attached are copies of the following documents:

9.1 (a) Registered Title

A Register Search Statement and the document, or part of a document, referred to as the 'diagram location' in that statement which identifies the land and its location.

9. SUBDIVISION

10.1 Unregistered Subdivision

This section 10.1 only applies if the land is subject to a subdivision which is not registered.

Not Applicable.

10.2 Staged Subdivision

This section 10.2 only applies if the land is part of a staged subdivision within the meaning of section 37 of the *Subdivision Act 1988*.

Not Applicable.

10.3 Further Plan of Subdivision

This section 10.3 only applies if the land is subject to a subdivision in respect of which a further plan within the meaning of the *Subdivision Act 1988* is proposed.

Not Applicable.

11. DISCLOSURE OF ENERGY INFORMATION

(Disclosure of this information is not required under section 32 of the Sale of Land Act 1962 but may be included in this vendor statement for convenience.)

Details of any energy efficiency information required to be disclosed regarding a disclosure affected building or disclosure area affected area of a building as defined by the *Building Energy Efficiency Disclosure Act 2010* (Cth)

- (a) to be a building or part of a building used or capable of being used as an office for administrative, clerical, professional or similar based activities including any support facilities; and
- (b) which has a net lettable area of at least 1000m²; (but does not include a building under a strata title system or if an occupancy permit was issued less than 2 years before the relevant date):

Not Applicable.

12. DUE DILIGENCE CHECKLIST

(The Sale of Land Act 1962 provides that the vendor or the vendor's licensed estate agent must make a prescribed due diligence checklist available to purchasers before offering land for sale that is vacant residential land or land on which there is a residence. The due diligence checklist is NOT required to be provided with, or attached to, this vendor statement but the checklist may be attached as a matter of convenience.)

- Vacant Residential Land or Land with a Residence
- Attach Due Diligence Checklist (this will be attached if ticked)

13. ATTACHMENTS

(Any certificates, documents and other attachments may be annexed to this section 13)

(Additional information may be added to this section 13 where there is insufficient space in any of the earlier sections)

(Attached is an "Additional Vendor Statement" if section 1.3 (Terms Contract) or section 1.4 (Sale Subject to Mortgage) applies)

1. Due diligence checklist;
2. Title statement volume 08124 folio 437;
3. Plan TP323076B;
4. Planning property report;
5. Land information certificate;
6. Water information statement;
7. Land tax clearance certificate; and
8. Lease agreement.

Due diligence checklist

What you need to know before buying a residential property

Before you buy a home, you should be aware of a range of issues that may affect that property and impose restrictions or obligations on you, if you buy it. This checklist aims to help you identify whether any of these issues will affect you. The questions are a starting point only and you may need to seek professional advice to answer some of them. You can find links to organisations and web pages that can help you learn more, by visiting the [Due diligence checklist page on the Consumer Affairs Victoria website](http://consumer.vic.gov.au/duediligencechecklist) (consumer.vic.gov.au/duediligencechecklist).

Urban living

Moving to the inner city?

High density areas are attractive for their entertainment and service areas, but these activities create increased traffic as well as noise and odours from businesses and people. Familiarising yourself with the character of the area will give you a balanced understanding of what to expect.

Is the property subject to an owners corporation?

If the property is part of a subdivision with common property such as driveways or grounds, it may be subject to an owners corporation. You may be required to pay fees and follow rules that restrict what you can do on your property, such as a ban on pet ownership.

Growth areas

Are you moving to a growth area?

You should investigate whether you will be required to pay a growth areas infrastructure contribution.

Flood and fire risk

Does this property experience flooding or bushfire?

Properties are sometimes subject to the risk of fire and flooding due to their location. You should properly investigate these risks and consider their implications for land management, buildings and insurance premiums.

Rural properties

Moving to the country?

If you are looking at property in a rural zone, consider:

- Is the surrounding land use compatible with your lifestyle expectations? Farming can create noise or odour that may be at odds with your expectations of a rural lifestyle.
- Are you considering removing native vegetation? There are regulations which affect your ability to remove native vegetation on private property.
- Do you understand your obligations to manage weeds and pest animals?

Can you build new dwellings?

Does the property adjoin crown land, have a water frontage, contain a disused government road, or are there any crown licences associated with the land?

Is there any earth resource activity such as mining in the area?

You may wish to find out more about exploration, mining and quarrying activity on or near the property and consider the issue of petroleum, geothermal and greenhouse gas sequestration permits, leases and licences, extractive industry authorisations and mineral licences.

Soil and groundwater contamination

Has previous land use affected the soil or groundwater?

You should consider whether past activities, including the use of adjacent land, may have caused contamination at the site and whether this may prevent you from doing certain things to or on the land in the future.

Land boundaries

Do you know the exact boundary of the property?

You should compare the measurements shown on the title document with actual fences and buildings on the property, to make sure the boundaries match. If you have concerns about this, you can speak to your lawyer or conveyancer, or commission a site survey to establish property boundaries.

Planning controls

Can you change how the property is used, or the buildings on it?

All land is subject to a planning scheme, run by the local council. How the property is zoned and any overlays that may apply, will determine how the land can be used. This may restrict such things as whether you can build on vacant land or how you can alter or develop the land and its buildings over time.

The local council can give you advice about the planning scheme, as well as details of any other restrictions that may apply, such as design guidelines or bushfire safety design. There may also be restrictions – known as encumbrances – on the property's title, which prevent you from developing the property. You can find out about encumbrances by looking at the section 32 statement.

Are there any proposed or granted planning permits?

The local council can advise you if there are any proposed or issued planning permits for any properties close by. Significant developments in your area may change the local 'character' (predominant style of the area) and may increase noise or traffic near the property.

Safety

Is the building safe to live in?

Building laws are in place to ensure building safety. Professional building inspections can help you assess the property for electrical safety, possible illegal building work, adequate pool or spa fencing and the presence of asbestos, termites, or other potential hazards.

Building permits

Have any buildings or retaining walls on the property been altered, or do you plan to alter them?

There are laws and regulations about how buildings and retaining walls are constructed, which you may wish to investigate to ensure any completed or proposed building work is approved. The local council may be able to give you information about any building permits issued for recent building works done to the property, and what you must do to plan new work. You can also commission a private building surveyor's assessment.

Are any recent building or renovation works covered by insurance?

Ask the vendor if there is any owner-builder insurance or builder's warranty to cover defects in the work done to the property.

Utilities and essential services

Does the property have working connections for water, sewerage, electricity, gas, telephone and internet?

Unconnected services may not be available, or may incur a fee to connect. You may also need to choose from a range of suppliers for these services. This may be particularly important in rural areas where some services are not available.

Buyers' rights

Do you know your rights when buying a property?

The contract of sale and section 32 statement contain important information about the property, so you should request to see these and read them thoroughly. Many people engage a lawyer or conveyancer to help them understand the contracts and ensure the sale goes through correctly. If you intend to hire a professional, you should consider speaking to them before you commit to the sale. There are also important rules about the way private sales and auctions are conducted. These may include a cooling-off period and specific rights associated with 'off the plan' sales. The important thing to remember is that, as the buyer, you have rights.

(04/10/2016)

VOLUME 08124 FOLIO 437

Security no : 124081596527C
Produced 12/02/2020 10:36 AM

LAND DESCRIPTION

Lot 1 on Title Plan 323076B.
PARENT TITLE Volume 04545 Folio 922
Created by instrument A207468 13/08/1956

REGISTERED PROPRIETOR

Estate Fee Simple
Sole Proprietor
VISANN PROPERTIES PTY LTD of 22 FULLHAM GROVE RESERVOIR VIC 3073
AR947600Y 21/02/2019

ENCUMBRANCES, CAVEATS AND NOTICES

MORTGAGE AS034080G 25/03/2019
AFSH NOMINEES PTY LTD

Any encumbrances created by Section 98 Transfer of Land Act 1958 or Section 24 Subdivision Act 1988 and any other encumbrances shown or entered on the plan set out under DIAGRAM LOCATION below.

DIAGRAM LOCATION

SEE TP323076B FOR FURTHER DETAILS AND BOUNDARIES

ACTIVITY IN THE LAST 125 DAYS

NIL

-----END OF REGISTER SEARCH STATEMENT-----

Additional information: (not part of the Register Search Statement)

Street Address: 21 WILLIAMS STREET OUYEN VIC 3490

ADMINISTRATIVE NOTICES

NIL

eCT Control 18440T MSA NATIONAL
Effective from 25/03/2019

DOCUMENT END

Imaged Document Cover Sheet

The document following this cover sheet is an imaged document supplied by LANDATA®, Victorian Land Registry Services.

Document Type	plan
Document Identification	TP323076B
Number of Pages (excluding this cover sheet)	1
Document Assembled	12/02/2020 10:38

Copyright and disclaimer notice:

© State of Victoria. This publication is copyright. No part may be reproduced by any process except in accordance with the provisions of the Copyright Act 1968 (Cth) and for the purposes of Section 32 of the Sale of Land Act 1962 or pursuant to a written agreement. The information is only valid at the time and in the form obtained from the LANDATA® System. None of the State of Victoria, LANDATA®, Victorian Land Registry Services Pty. Ltd. ABN 86 627 986 396 as trustee for the Victorian Land Registry Services Trust ABN 83 206 746 897 accept responsibility for any subsequent release, publication or reproduction of the information.

The document is invalid if this cover sheet is removed or altered.

Location of Land

Pansh: OUYEN
 Township:
 Section: A
 Crown Allotment: 11(PT)
 Crown Portion:

Last Plan Reference:

Derived From: VOL 8124 FOL 437
 Depth Limitation: 50 FEET

Notations

IN THE MALLEE COUNTRY FOR THE PURPOSES OF THE LAND ACT

ANY REFERENCE TO MAP IN THE TEXT MEANS THE DIAGRAM SHOWN ON THIS TITLE PLAN

Description of Land / Easement Information

THIS PLAN HAS BEEN PREPARED FOR THE LAND REGISTRY, LAND VICTORIA, FOR TITLE DIAGRAM PURPOSES AS PART OF THE LAND TITLES AUTOMATION PROJECT
 COMPILED: 18/02/2000
 VERIFIED: GB

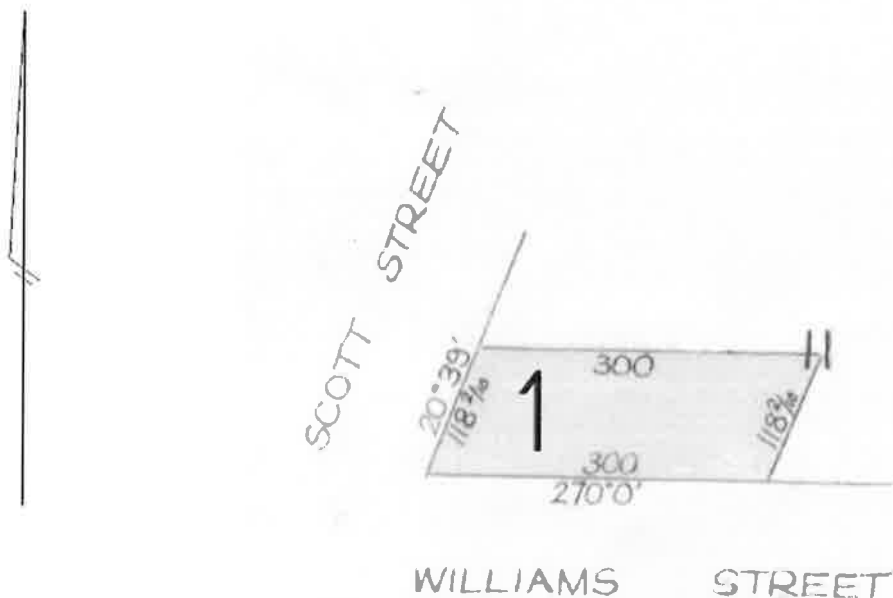

TABLE OF PARCEL IDENTIFIERS

WARNING: Where multiple parcels are referred to or shown on this Title Plan this does not imply separately disposable parcels under Section 8A of the Sale of Land Act 1962

PARCEL 1 = CA 11 (PT)

PLANNING PROPERTY REPORT

From www.planning.vic.gov.au on 12 February 2020 10:39 AM

PROPERTY DETAILS

Address: **21 WILLIAMS STREET OUYEN 3490**
Lot and Plan Number: **Lot 1 TP323076**
Standard Parcel Identifier (SPI): **1\TP323076**
Local Government Area (Council): **MILDURA**
Council Property Number: **12076**
Planning Scheme: **Mildura**
Directory Reference: **VicRoads 540 G8**

www.mildura.vic.gov.au

planning-schemes.delwp.vic.gov.au/schemes/mildura

UTILITIES

Rural Water Corporation: **Grampians Wimmera Mallee Water**
Urban Water Corporation: **Grampian Wimmera Malle Water**
Melbourne Water: **outside drainage boundary**
Power Distributor: **POWERCOR**

STATE ELECTORATES

Legislative Council: **NORTHERN VICTORIA**
Legislative Assembly: **MILDURA**

Planning Zones

[TOWNSHIP_ZONE \(TZ\)](#)

[SCHEDULE TO THE TOWNSHIP_ZONE \(TZ\)](#)

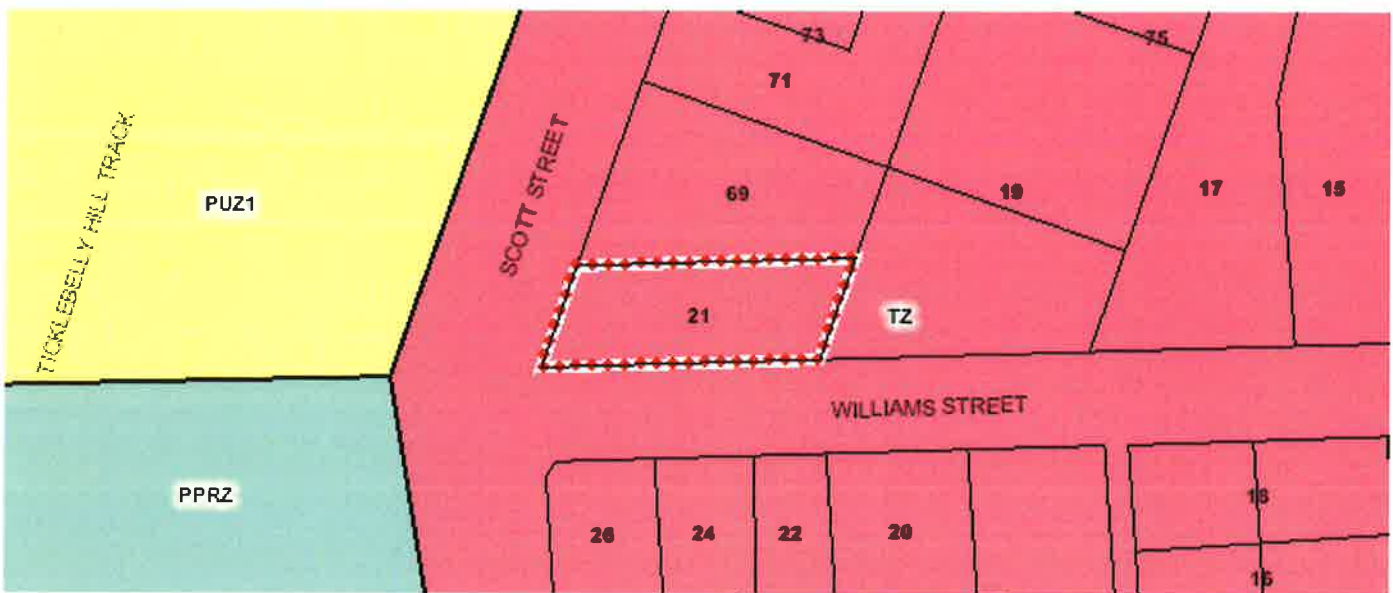

Copyright © - State Government of Victoria

PPRZ - Public Park & Recreation PUZ1 - Public Use - Service & Utility TZ - Township

Note: labels for zones may appear outside the actual zone - please compare the labels with the legend.

Copyright © - State Government of Victoria

Disclaimer: This content is provided for information purposes only. No claim is made as to the accuracy or authenticity of the content. The Victorian Government does not accept any liability to any person for the information provided. Read the full disclaimer at www.land.vic.gov.au/home/copyright-and-disclaimer

Notwithstanding this disclaimer, a vendor may rely on the information in this report for the purpose of a statement that land is in a bushfire prone area as required by section 32C (b) of the Sale of Land 1962 (Vic).

Planning Overlay

None affecting this land

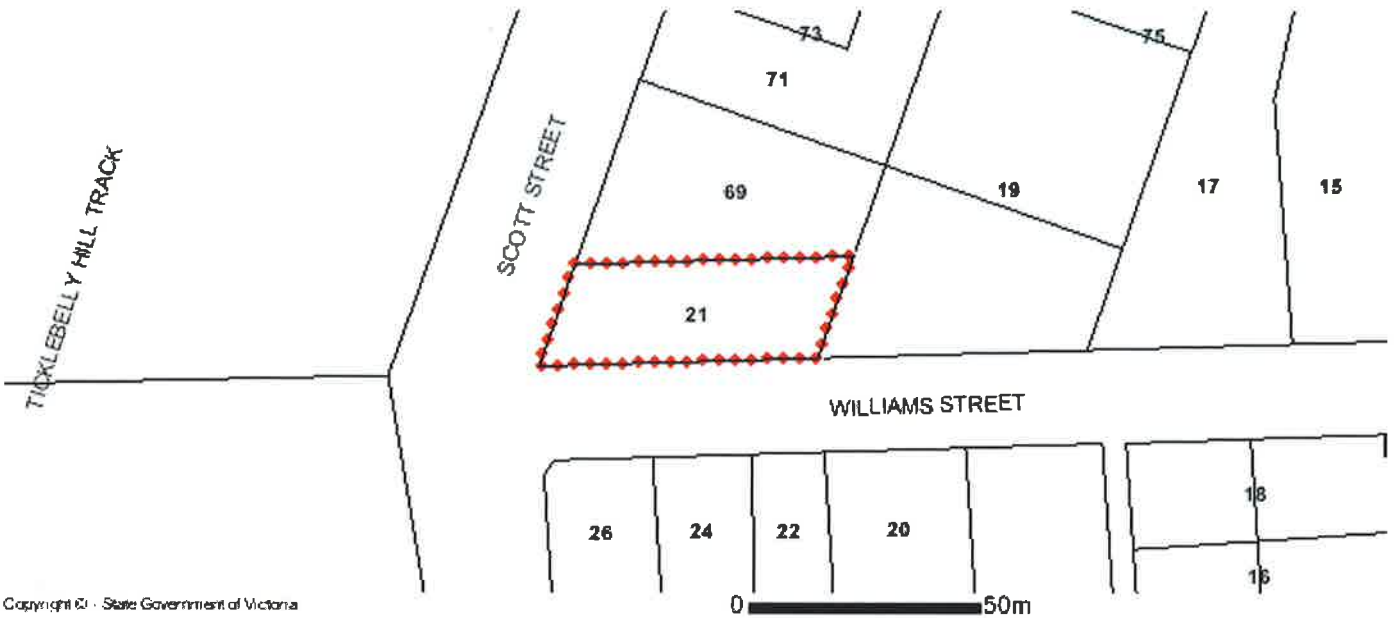

Copyright © - State Government of Victoria

Note: due to overlaps, some overlays may not be visible, and some colours may not match those in the legend.

Areas of Aboriginal Cultural Heritage Sensitivity

All or part of this property is an 'area of cultural heritage sensitivity'.

'Areas of cultural heritage sensitivity' are defined under the Aboriginal Heritage Regulations 2018, and include registered Aboriginal cultural heritage places and land form types that are generally regarded as more likely to contain Aboriginal cultural heritage.

Under the Aboriginal Heritage Regulations 2018, 'areas of cultural heritage sensitivity' are one part of a two part trigger which require a 'cultural heritage management plan' be prepared where a listed 'high impact activity' is proposed.

If a significant land use change is proposed (for example, a subdivision into 3 or more lots), a cultural heritage management plan may be triggered. One or two dwellings, works ancillary to a dwelling, services to a dwelling, alteration of buildings and minor works are examples of works exempt from this requirement.

Under the Aboriginal Heritage Act 2006, where a cultural heritage management plan is required, planning permits, licences and work authorities cannot be issued unless the cultural heritage management plan has been approved for the activity.

For further information about whether a Cultural Heritage Management Plan is required go to

<http://www.aav.nrms.net.au/aavQuestion1.aspx>

More information, including links to both the Aboriginal Heritage Act 2006 and the Aboriginal Heritage Regulations 2018, can also be found here - <https://www.vic.gov.au/aboriginalvictoria/heritage/planning-and-heritage-management-processes.html>



Aboriginal Heritage

Further Planning Information

Planning scheme data last updated on 5 February 2020.

A **planning scheme** sets out policies and requirements for the use, development and protection of land. This report provides information about the zone and overlay provisions that apply to the selected land. Information about the State and local policy, particular, general and operational provisions of the local planning scheme that may affect the use of this land can be obtained by contacting the local council or by visiting <https://www.planning.vic.gov.au>

This report is NOT a **Planning Certificate** issued pursuant to Section 199 of the *Planning and Environment Act 1987*. It does not include information about exhibited planning scheme amendments, or zonings that may affect the land. To obtain a Planning Certificate go to Titles and Property Certificates at Landata - <https://www.landata.vic.gov.au>

For details of surrounding properties, use this service to get the Reports for properties of interest.

To view planning zones, overlay and heritage information in an interactive format visit <http://mapshare.maps.vic.gov.au/vicplan>

For other information about planning in Victoria visit <https://www.planning.vic.gov.au>

Designated Bushfire Prone Area

This property is in a designated bushfire prone area.
Special bushfire construction requirements apply. Planning provisions may apply.

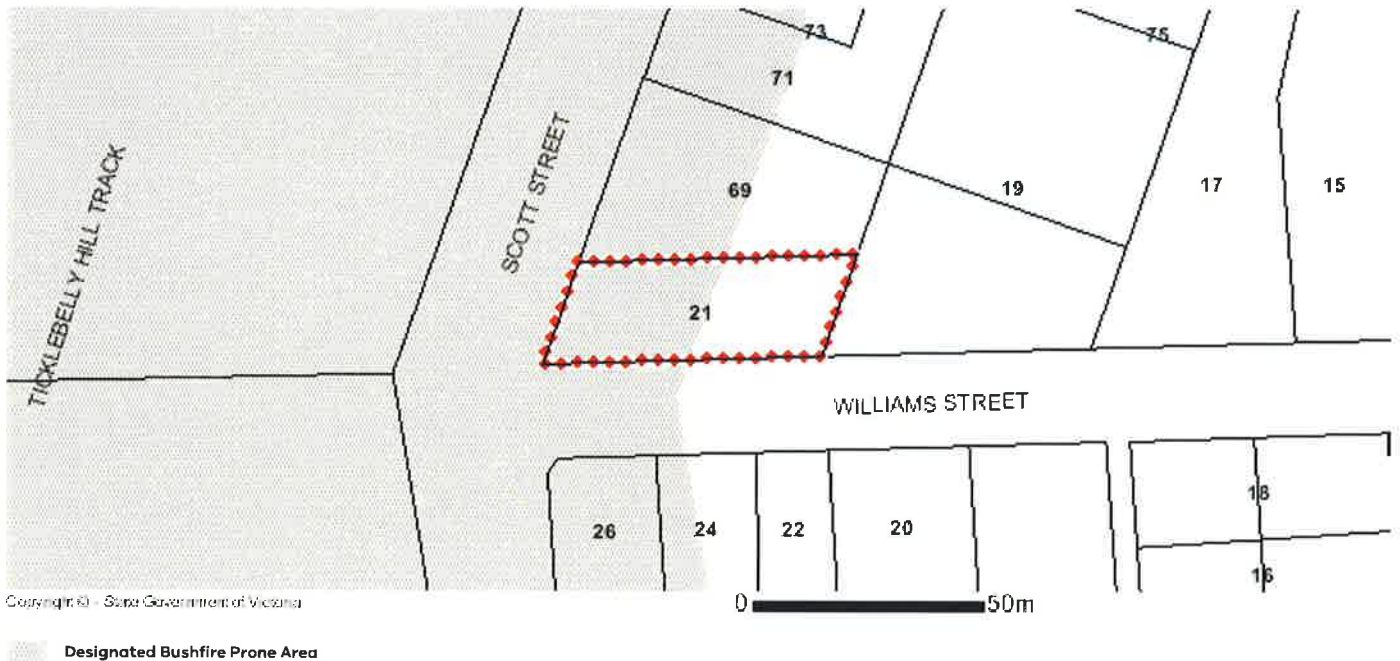

Designated bushfire prone areas as determined by the Minister for Planning are in effect from 8 September 2011 and amended from time to time.

The Building Regulations 2018 through application of the Building Code of Australia, apply bushfire protection standards for building works in designated bushfire prone areas.

Designated bushfire prone areas maps can be viewed on VicPlan at <http://mapshare.maps.vic.gov.au/vicplan> or at the relevant local council.

Note: prior to 8 September 2011, the whole of Victoria was designated as bushfire prone area for the purposes of the building control system.

Further information about the building control system and building in bushfire prone areas can be found on the Victorian Building Authority website www.vba.vic.gov.au

Copies of the Building Act and Building Regulations are available from www.legislation.vic.gov.au

For Planning Scheme Provisions in bushfire areas visit <https://www.planning.vic.gov.au>



Mildura Rural City Council

Land Information Certificate

Date of certificate: 13 February 2020

SECTION 229 LOCAL GOVERNMENT ACT 1989

Certificate No: 21780

Assessment No: 12076

Your Reference: 35270941-011-7

Applicant Details

Landata
DX 250639
EAST MELBOURNE VIC

Property Address: 21 Williams Street OUYEN

Description: Lot: 1 Sec: A TP: 323076B

Area: 1,324.0000 Square Metres

Capital Improved Value	\$81,000
Site Value	\$24,000
Net Annual Value	\$4,050
Base Date:	01/01/2019

RATES CHARGES AND OTHER MONIES: FOR THE 2019-2020 FINANCIAL YEAR

(Current rates and charges are payable in one lump sum by 15 February or by quarterly instalments due (1st) 30 September, (2nd) 30 November, (3rd) 28 February and (4th) 31 May of this financial year.)

Residential Rate	\$520.85
Waste Management - Mallee Towns	\$366.04
Residential Fire Levy (Fixed)	\$111.00
Residential Fire Levy (Variable)	\$5.35
Rate Arrears to 30/06/2019:	\$0.00
Interest to 13/02/2020:	\$0.00
Other Monies:	\$0.00
Less Rebates:	\$0.00
Less Payments:	-\$501.62
Total Rates & Charges Due:	\$501.62
Additional Monies Owed:	
Debtor Balance Owing:	
Total Rates & Charges & Additional Monies Owed:	\$501.62

Pay via BPay Biller Code: 93922

Reference Number: 120766

For further information contact
Rates Department
Mildura Rural City Council
PO Box 105, Mildura Vic 3502; or
DX 50014, Mildura
Telephone: (03) 5018 8122

Certificate updates
Certificates are valid for 90 days from the original date of issue. Updates may be requested by the applicant only. All update requests must be submitted via the following email address:
helpdesk-revenue@mildura.vic.gov.au



Mildura Rural City Council

Land Information Certificate

Date of certificate: 13 February 2020

SECTION 229 LOCAL GOVERNMENT ACT 1989

Certificate No: 21780

Assessment No: 12076

Your Reference: 35270941-011-7

Property Address: 21 Williams Street OUYEN 3490

Description: Lot: 1 Sec: A TP: 323076B

This certificate provides information regarding valuation, rates, charges, other moneys owing and any orders and notices made under the **Local Government Act 1989**, the **Local Government Act 1958** or under a local law of the Council.

There are no monies owed for works under the **Local Government Act 1958** or earlier act.

There are no monies owed under Section 94(5) of the **Electricity Industry Act 2000**.

There is no potential liability for rates under the **Cultural and Recreational Lands Act 1963**.

There is not any outstanding amount required to be paid for recreational purposes or any transfer of land required to be made to Council for recreational purposes under Section 18 of the **Subdivision Act 1988** or the **Local Government Act 1958**.

There are not any notices or orders on the land that have been served by Council under the **Local Government Act 1958**, **Local Government Act 1989**, any other Act or regulation, or under a local law of the Council, which have a continuing application as at the date of this certificate.

There is not a potential liability for the land to become rateable under Section 173 or 174A of the **Local Government Act 1989** unless stated in 'Please Note'.

There is no money owed under Section 227 of the **Local Government Act 1989**.

This certificate is not required to (and does not) include information regarding planning, building, health, land fill, land slip, flooding information or service easements. Information regarding these matters may be available from Council or the relevant authority. A fee may be charged for such information.

PLEASE NOTE: Interest on 3rd instalment will be raised after 28/02/20 if unpaid. Please apply for an update if settlement occurs after this date.

I hereby certify that the information given in this certificate is a true and correct disclosure of rates and other monies payable to the Mildura Rural City Council as at the above date, together with any notices served pursuant to the Local Government Act, Local Law or any other Act.

..... DELEGATED OFFICER

RECEIPT OF \$27.00 ACKNOWLEDGED, BEING THE FEE FOR THIS CERTIFICATE.



GWMWater

11 McLachlan Street
(PO Box 481)
Horsham Victoria 3402

Tel: 1300 659 961

Fax: 03 5381 9881

Email: info@gwmwater.org.au

Website: www.gwmwater.org.au

Domantay Legal Pty Ltd
C/- InfoTrack C/- Landata
Level 1, 2 Lonsdale Street
MELBOURNE VIC 3000

Your Ref: 35270941-022-3
Statement No: CER2019/01454
Property No: 145617
Valid Date: 12/02/2020
Settlement Date: 12/02/2020

Information Statement

Water Act 1989, Section 158

Statement of encumbrances, works required, outstanding matters, tariffs and other charges including outstanding amounts and other information which the Corporation considers relevant for the property known as:

21 Williams Street OUYEN VIC 3490

Title(s):

L1 TP323076B V8124 F437

Owner(s):

Visann Properties Pty Ltd

Account Calculations:

Fees and Charges (including interest)	\$0.00
Scheme Arrears	
Total amount in arrears:	\$0.00
<small>(Amounts below do not include any pensions rebates or concessions)</small>	
Charges to: 12/02/2020 (from page 2)	\$109.28
Total amount:	\$109.28

Info Stmt No: CER2019/01454

Property Address: 21 Williams Street OUYEN VIC 3490

Details for Services provided and their tariffs:

METERED SERVICE: 27154 (20mm) Meter Number: 19V42217T	
Water SAC Residential 20mm: From 01/01/20 To 12/02/20 = 42 days @ 124.44¢ per day =	\$52.26
Wastewater Service Availability: From 01/01/20 To 12/02/20 = 42 days @ 135.76¢ per day =	\$57.02

----- PLEASE NOTE -----

1. In accordance with Section 275(1) of the *Water Act 1989*, the person/s who becomes the owners of a property must pay any amount that is under Section 274 (4a) a charge on that property. All unpaid charges must be paid in full upon settlement.
2. The statement may include estimate volumetric consumption from the last meter read. Should you require a special reading this may be applied for upon payment of a \$33.65 fee.
3. All measurements used for encumbrances are to be assumed to be estimations of locations. Further details should be obtained from the Corporation before works are commenced.

AMOUNTS SHOULD BE CONFIRMED PRIOR TO SETTLEMENT

Encumbrances and other information:

This property is not subject to encumbrances resulting from works of the Corporation. There are no works, matters or other details to be disclosed.

An update is recommended closer to settlement date to reflect any new charges raised, meter readings or payments received. Please note that statements will only be updated for three months after the valid date.

Tenant is responsible for water consumption. When tenant vacates property a \$33.65 special meter reading fee will be applied to this account.

The Water Service Availability Charge will vary dependent on the property owner's concession entitlements.

B-Pay Biller Code: 79855 Account Reference Number: 2379600

Comments:

Signed



Authorised Officer
Steven Briggs, Manager Customer Services

LANDATA® Property Enquiry Application Form

This application was lodged on 12-02-2020 using the LANDATA® System.	Agency Ref. Code Agency Application No.
AUTHORITY: 530 GRAMPIANS WIMMERA-MALLEE RURAL WATER (Urban) P.O. Box 481 Horsham 3402	Municipal Property No. CPN=12076(NRE) Standard Parcel Identifiers: 1\TP323076 CERTIFICATE NAME: Water Information Statement FEE ENCLOSED: \$56.15
VENDOR: Visann Properties Pty Ltd ✓	PURCHASER: N/A, N/A
NAME AND ADDRESS OF REG'D PROP. IF NOT VENDOR:	VENDORS SOLICITOR:
APPLICANT: C/O LANDATA® * Domantay Legal Pty Ltd C/- InfoTrack c/o LANDATA (fax 9194 0616) ✓ DX 250639 or GPO Box 527 Melbourne, Victoria 3001 DX No. 250639	Applicant's Reference: 35270941-022-3 ✓ Total Sale Price: \$0 Auction/Settlement Date: 12/02/2020 ✓ Terms of Sale: Contract Date: Applicant's Telephone No: 1800 738 524
Street No., Street, Road, etc. 21 WILLIAMS STREET	Town or Suburb OUYEN
Lot No./Plan No. Lot 1 TP323076B ✓ ✓	Municipality Postcode RURAL CITY OF MILDURA 3490
Volume/Folio or Book/Memorial 8124/437 ✓ ✓	
Crown Description(s)	
Additional References or Comments V11 F3,V540 G8	Parish Name of Directory Ouyen
Map Reference H/L Full Tenant 20mm Drainage Plan ✓ 145617 Non Encl 237 9600 ✓ + Part A	
Please return certificate to LANDATA® via: E-mail: Landata.online@victorianlrs.com.au (preferred) DX 250639 Melbourne Post: GPO Box 527 Melbourne, Victoria 3001	
* Please quote this number on your certificate LANDATA® Ref: 35270941-022-3	

P
D
C
C

PROCESSE
DMG
CHECKED

(12/2/20)
13/2/20



Copyright State of Victoria. This publication is copyright. No part may be reproduced by any process except in accordance with the provisions of the Copyright Act 1968 (Cth) and for the purposes of Section 32 of the Sale of Land Act 1962 (Vic) or pursuant to a written agreement. The information is only valid at the time and in the form obtained from the LANDATA REGD TM System. None of the State of Victoria, LANDATA REGD TM System, Victorian Land Registry Services Pty. Ltd. ABN 86 627 986 396 as trustee for the Victorian Land Registry Services Trust ABN 83 206 746 897 accept responsibility for any subsequent release, publication or reproduction of the information.

REGISTER SEARCH STATEMENT Land Titles Office, Victoria

Page 1

VOLUME 08124 FOLIO 437

Security no : 124081596527C
Produced 12/02/2020 10:36 AM

LAND DESCRIPTION

Lot 1 on Title Plan 323076B.
PARENT TITLE Volume 04545 Folio 922
Created by instrument A207468 13/08/1956

REGISTERED PROPRIETOR

Estate Fee Simple
Sole Proprietor
VISANN PROPERTIES PTY LTD of 22 FULLHAM GROVE RESERVOIR VIC 3073
AR947600Y 21/02/2019

ENCUMBRANCES, CAVEATS AND NOTICES

MORTGAGE AS034080G 25/03/2019
AFSH NOMINEES PTY LTD

Any encumbrances created by Section 98 Transfer of Land Act 1958 or Section 24 Subdivision Act 1988 and any other encumbrances shown or entered on the plan set out under DIAGRAM LOCATION below.

DIAGRAM LOCATION

SEE TP323076B FOR FURTHER DETAILS AND BOUNDARIES

ACTIVITY IN THE LAST 125 DAYS

NIL

-----END OF REGISTER SEARCH STATEMENT-----

Additional information: (not part of the Register Search Statement)

Street Address: 21 WILLIAMS STREET OUYEN VIC 3490

ADMINISTRATIVE NOTICES

NIL

eCT Control 18440T MSA NATIONAL
Effective from 25/03/2019

DOCUMENT END

© State of Victoria. This publication is copyright. No part may be reproduced by any process except in accordance with the provisions of the Copyright Act 1968 (Cth) and for the purposes of Section 32 of the Sale of Land Act 1962 or pursuant to a written agreement. The information is only valid at the time and in the form obtained from the LANDATA® System. None of the State of Victoria, LANDATA®, Victorian Land Registry Services Pty. Ltd. ABN 86 627 986 396 as trustee for the Victorian Land Registry Services Trust ABN 83 206 746 897 accept responsibility for any subsequent release, publication or reproduction of the information.

TITLE PLAN		EDITION 1	TP 323076B						
Location of Land Parish: OUYEN Township: Section: A Crown Allotment: 11(PT) Crown Portion: Last Plan Reference: Derived From: VOL 8124 FOL 437 Depth Limitation: 50 FEET		Notations IN THE MALLEE COUNTRY FOR THE PURPOSES OF THE LAND ACT ANY REFERENCE TO MAP IN THE TEXT MEANS THE DIAGRAM SHOWN ON THIS TITLE PLAN							
Description of Land / Easement Information			THIS PLAN HAS BEEN PREPARED FOR THE LAND REGISTRY, LAND VICTORIA, FOR TITLE DIAGRAM PURPOSES AS PART OF THE LAND TITLES AUTOMATION PROJECT COMPILED: 18/02/2000 VERIFIED: GB						
<table border="1" style="width: 100%; border-collapse: collapse;"> <tr> <th colspan="2" style="text-align: center;">TABLE OF PARCEL IDENTIFIERS</th> </tr> <tr> <td colspan="2" style="font-size: small;">WARNING: Where multiple parcels are referred to or shown on this Title Plan this does not imply separately disposable parcels under Section 8A of the Sale of Land Act 1962</td> </tr> <tr> <td colspan="2" style="font-size: small;">PARCEL 1 = CA 11 (PT)</td> </tr> </table>				TABLE OF PARCEL IDENTIFIERS		WARNING: Where multiple parcels are referred to or shown on this Title Plan this does not imply separately disposable parcels under Section 8A of the Sale of Land Act 1962		PARCEL 1 = CA 11 (PT)	
TABLE OF PARCEL IDENTIFIERS									
WARNING: Where multiple parcels are referred to or shown on this Title Plan this does not imply separately disposable parcels under Section 8A of the Sale of Land Act 1962									
PARCEL 1 = CA 11 (PT)									
LENGTHS ARE IN LINKS	Metres = 0.3048 x Feet Metres = 0.201168 x Links	Sheet 1 of 1 sheets							

Land Tax Clearance Certificate

Land Tax Act 2005



INFOTRACK / DOMANTAY LEGAL PTY LTD

Your Reference: 20/SG/1030

Certificate No: 34455425

Issue Date: 12 FEB 2020

Enquiries: ESYSPROD

Land Address: 21 WILLIAMS STREET OUYEN VIC 3490

Land Id	Lot	Plan	Volume	Folio	Tax Payable
23839828	1	323076	8124	437	\$84.00

Vendor: VISANN PROPERTIES PTY LTD

Purchaser: FOR INFORMATION PURPOSES

Current Land Tax	Year	Taxable Value	Proportional Tax	Penalty/Interest	Total
VISANN PROPERTIES TRUST	2020	\$24,000	\$84.00	\$0.00	\$84.00

Comments: Land Tax will be payable but is not yet due - please see note 6 on reverse.

Current Vacant Residential Land Tax	Year	Taxable Value	Proportional Tax	Penalty/Interest	Total
-------------------------------------	------	---------------	------------------	------------------	-------

Comments:

Arrears of Land Tax	Year	Proportional Tax	Penalty/Interest	Total
---------------------	------	------------------	------------------	-------

This certificate is subject to the notes that appear on the reverse. The applicant should read these notes carefully.

Paul Broderick
Commissioner of State Revenue

CAPITAL IMP VALUE:	\$81,000
SITE VALUE:	\$24,000
AMOUNT PAYABLE:	\$84.00

Notes to Certificates Under Section 105 of the *Land Tax Act 2005*

Certificate No: 34455425

- Under Section 96 of the *Land Tax Act 2005* (the Act), unpaid land tax (including special land tax and vacant residential land tax) is a first charge on the land to which it relates and should the vendor default, payment will be obtained from the purchaser. The purchaser should take into account the possibility that the vendor may default where land tax has been assessed but not paid.
- A purchaser who has obtained a Certificate is only liable to a charge on the land to the amount of unpaid land tax as certified by a Certificate. A purchaser must obtain the Certificate from the Commissioner. They cannot rely on the Certificate obtained by the vendor.
- If land tax (including special land tax and vacant residential land tax) is due but not paid on a property, the Land Tax Clearance Certificate will certify the amount of land tax due and payable on that land. This amount will be binding on the Commissioner of State Revenue (the Commissioner) for purposes of section 96 of the Act whether or not it is paid to the State Revenue Office (SRO) on, or shortly after, settlement.
- The amount of land tax on this certificate relates to the amount of land tax (including special land tax and vacant residential land tax) due and payable as at the date of the application only and not to any future liability or the tax status of the land.
- A 'Nil' Land Tax Clearance certificate does not mean that the land on the certificate is exempt from land tax or vacant residential land tax.
- If land tax (including special land tax or vacant residential land tax) will be payable on a property but payment is not due at the time the application is processed, the certificate will certify the amount that should be retained by the purchaser at settlement and remitted to the SRO. The Commissioner will consider himself bound by this amount against the purchaser, only if the amount is remitted to the SRO.
- If the amount in 4. (above) is understated, the Commissioner has the right to seek recovery of the correct amount, or the balance, as the case may be, from the:
 - vendor, or
 - purchaser, if the vendor defaults and the certified amount has not been remitted to the SRO.
- If an amount is certified in respect of a proposed sale which is not completed, the Commissioner will not be bound by the same amount in respect of a later sale of the subject land - another certificate must be applied for in respect of that transaction.
- If an amount certified is excessively high (for example, because an exemption or concession has not been deducted in calculating the amount) the Commissioner will issue an amended certificate, without an additional fee being charged on receipt of sufficient evidence to that effect from the vendor.
- If no land tax (including special land tax or vacant residential land tax) is stated as being payable in respect of the property, the Commissioner will consider himself bound by that certification, in respect of the purchaser, if the land is subsequently found to be taxable and the vendor defaults.
- If the vendor refuses to be bound by an amount stated by the Commissioner and does not agree to the amount being withheld and remitted at settlement, the purchaser cannot rely on such refusal as a defence to an action by the Commissioner to recover the outstanding amount from the purchaser under Sections 96 or 98 of the Act.
- The information on a certificate cannot preclude the Commissioner from taking action against a vendor to recover outstanding land tax (including special land tax and vacant residential land tax).
- You can request a free update of a Land Tax Clearance Certificate via our website if:
 - there is no change to the parties involved in the transaction, and
 - the request is within 90 days of the original certificate being issued.

For Information Only

LAND TAX CALCULATION BASED ON SINGLE OWNERSHIP

Land Tax = \$0.00

Taxable Value = \$24,000

Calculated as \$0 plus (\$24,000 - \$0) multiplied by 0.000 cents.

Land Tax Clearance Certificate - Payment Options

BPAY



Billers Code: 5249
Ref: 34455425

Telephone & Internet Banking - BPAY®

Contact your bank or financial institution to make this payment from your cheque, savings, debit or transaction account.

www.bpay.com.au

CARD



Ref: 34455425

Visa or Mastercard.

Pay via our website or phone 13 21 61.
A card payment fee applies.

sro.vic.gov.au/paylandtax

GORDON AGENCIES
Residential Tenancy Agreement
Residential Tenancies Act 1997
Conditions of Agreement

1. This Agreement is made on the date specified in Item 1 in the Schedule hereto between the Landlord whose name and address is specified in Item 2 in the Schedule whose agent is specified in Item 3 in the Schedule and the Tenant whose name and address is specified in Item 4 in the Schedule.

Premises and Rent

The Landlord lets to the Tenant the Premises specified in item 5 in the Schedule together with those items indicated in the Schedule, for which the Rental shall be the amount specified in Item 6 in the Schedule of which the first instalment is payable on the date specified in item 7 of the Schedule and payable by the Tenant to the party specified in item 8 in the Schedule.

Bond

The Tenant shall pay a Bond of the amount specified in Item 9 of the Schedule to the Landlord/Agent on or before the signing of this Agreement. In accordance with the Residential Tenancies Act 1997 the Landlord/Agent must lodge the Bond with the Residential Tenancies Authority within 5 business days of receiving the Bond.

Fixed Term Tenancy

The term of this Agreement shall be as specified in Item 11 of the Schedule Commencement on the date specified in Item 12 in the Schedule and Ending on the date specified in Item 13 in the Schedule and unless either party terminates this Agreement in accordance with the provisions of the Residential Tenancies Act 1997 this Agreement shall then continue as a periodic tenancy.

OR

Periodic Tenancy

This Agreement shall commence on the date specified in Item 14 in the Schedule and continue until terminated in accordance with the Residential Tenancies Act 1997.

1. **Condition of the Premises**

The Landlord shall make sure that the premises are maintained in good repair.

3. **Damage to the Premises**

- (a) The Tenant must ensure that care is taken to avoid damaging the rented premises.
- (b) The Tenant must take reasonable care to avoid damaging the premises and any common areas.
- (c) The Tenant who becomes aware of damage to the rented premises must give notice to the Landlord of any damage to the premises as soon as practicable.

4. **Cleanliness of the premises**

- (a) The Landlord shall make sure that the premises are in a reasonably clean condition on the day on which it is agreed that the Tenant is to enter in to occupation of the premises.
- (b) The Tenant must keep the premises in a reasonably clean condition during the period of the Agreement.

5. **Use of Premises**

- (a) The Tenant must not use or allow the premises to be used for any illegal purpose.
- (b) The Tenant must not use or allow the premises to be used in such a manner as to cause a nuisance or premises.

6. **Quiet Enjoyment**

The Landlord must take all reasonable steps to make sure that the Tenant has quiet enjoyment of the premises.

7. **Assignment or sub-letting**

- (a) The Tenant must not assign or sub-let the whole or any part of the premises without the written consent of the Landlord. The Landlord's consent must not be unreasonably withheld.
- (b) The Landlord must not demand or receive any fee or payment for the consent, except in respect of any fees, costs or charges incurred by the Landlord in relation to the preparation of an assignment in writing of the Agreement.

8. **Residential Tenancies Act 1997**

- (a) Each party must comply with the Residential Tenancies Act 1997.
- (b) For further rights and duties refer to the Residential Tenancies Act 1997.

I acknowledge that I have read and fully understand and agree to all of the above. Initial: Tenant 1...k4.. Tenant 2

Additional Terms: Special Conditions

Additional terms which to not take away the rights and duties included in the Residential Tenancies Act 1997 may be set out in this Section.

VACATING

9. Should the Tenant find it essential to vacate the premises before the expiry of the lease, he/she agrees to-
 - a) Immediately inform the Managing Agent of his/her desire to do so, and do so in writing. A minimum of 28 days notice must be given.
 - b) Continue to pay rent & maintain the lawns & gardens in accordance with the lease until the commencement of the following tenancy.
 - c) A lease break fee in proportion to the unexpired portion of the Tenancy Agreement at the rate one and half weeks rent plus GST plus \$66.00 inc gst for advertising associated with securing a new tenant and Lower Murray Water meter reading fee of \$45.50.
 - d) Leave the premises in a reasonably clean and undamaged condition as per entry condition report.
10. The Tenant acknowledges that pursuant to Section 428 of the Residential Tenancies Act 1997-Tenant shall not use Bond as rent - the Tenant shall not refuse to pay rent on the ground that the Tenant intends to regard as rent paid by the Tenant the Bond or any part of the Bond paid in respect of the Premises. The Tenant acknowledges that failure to abide by this section of the Act renders the Tenant liable to a penalty of \$1000.
11. If the Tenant wishes to vacate the premises at the expiration of this Agreement the Tenant shall give the Landlord or Agent written notice of the Tenants intention to vacate 28 days prior to the expiration of the Agreement. If the Tenant remains in occupation of the premises after the expiration of this agreement and does not enter into a new fixed term Agreement the Tenant must give written notice of the Tenant's intention to vacate the premises specifying a termination date that is not earlier than 28 days after the day on which the Tenant gave notice.
 - (a) Upon termination of the lease the Tenant must leave the premises in a clean and tidy state as per entry condition report, free of Odours , Pet etc, otherwise the cost of work carried out to restore the premises to a clean and tidy state, will be charged to the tenant.
 - (b) The Tenant agrees to have the carpets professionally cleaned and supply a receipt upon returning keys and remotes (where supplied).
12. The Tenant hereby agrees that if there is a change in tenancy, we will require the outgoing tenant to immediately notify our office in writing. When this letter is received we will notify the Landlord. If a new Tenant is moving in to replace the outgoing Tenant, the new Tenant will be required to complete an application form and the new applicant needs to be approved by the Landlord. Once the Landlord has approved the new Tenant, a Bond Transfer form must be completed and signed by all Tenants and there is an administration fee of \$55.00 inc gst to be paid to our office before the new tenant can move in.

KEYS/LOCKS

13.
 - (a) The Tenant acknowledges that it is the Tenants responsibility upon the termination of the Agreement to deliver ALL keys and remotes were supplied to the premises to the Agent's office and to continue paying rent until such time as ALL keys are delivered.
 - (b) The Tenant is hereby responsible for the replacement for lost keys or remotes and the provision of additional keys or remotes and any locksmith charges where keys or remotes are lost or mislaid.
 - (c) The Landlord acknowledges the Tenant right to change the locks at the rental property provided a duplicate key is given to the landlord or managing Agent. In-going Tenant may also re program remotes all at their own expense.
 - (d) The Tenant acknowledges that whilst all due care and attention has been taken, the Landlord cannot guarantee that all keys to the property were returned by the previous occupants.

RENT

14. The rent must be one week in advance at all times. Always contact the agent if you are unable to pay it by the due date. A TERMINATION NOTICE will automatically be issued should rental fall fourteen days in arrears. A warning will NOT be given prior to the Notice being given.
15. The Tenant hereby acknowledges that should any cheque tendered in payment of rent and/or monies due under this lease and any overholding period not to be honoured in normal course by the bank on the first presentation then subsequent payment shall be the way of cash or certified bank cheque. The Tenant also agrees to pay all bank charges and associated costs resulting from dishonour.
16. In accordance with the provisions of Section 44 of the Residential Tenancies Act 1997, the Landlord may, other than within the terms specified in the Schedule as the fixed term, increase the rent by giving the Tenant at least 60 days notice of the increase.

GENERAL

17. The Tenant agrees to fully and regularly maintain and water (as per LMW restrictions) the lawns and gardens areas, including the trees and shrubs, to mow and edge the lawns and to remove all garden rubbish from the property.
18. The Tenant agrees not to smoke or allow guests to smoke inside the premises under any circumstances. The Tenant agrees to go outside and will ensure their guests go outside to smoke. If walls and ceilings are damaged from smoking they will need to be repainted at the tenants expense. Therefore it is a requirement that smoking be outside only.
19. The Tenant must pay all charges in respect of the re-connection and consumption of water, electricity, gas, oil and telephone where the rented premises is separately metered for these services.
20. The Tenant shall not do or allow anything to be done which would invalidate any insurance policy on the premises or increase the premium and the Tenant shall pay the Landlord all increased premiums and all other expense incurred as a consequence of any breach of this term.
21. The Tenant shall not keep or use in the premises any portable kerosene heaters, oil burning heaters or heaters of a similar kind with naked flame including portable gas stoves.
22. The Tenant shall indemnify the Landlord against all liability in respect of injury or damage to any third person or third party property arising from any conduct, act or omission by the Tenant, or the Tenant servants, Agents and/or invitees.

I acknowledge that I have read and fully understand and agree to all of the above. Initial: Tenant 1.....Tenant 2

23. The Tenant acknowledges that the Tenant shall insure their possessions. The Tenant also acknowledges that the Landlord's insurance policy will not provide cover for such possessions. It is not your Landlord/s responsibility to insure your possessions. The Landlord's insurance policy covers only the building plus any of the Landlord/s fixtures and fittings. With the ever increasing incidence of burglary and theft, it is strongly recommended that you take out contents insurance cover.
24. The Tenant agrees to pay the Landlord any excess amount charged or any additional premium charged by Landlord's Insurance Company as a result of accidental breakage of glass, toilet bowls and wash basins in the premises where the damage has been caused by the tenant, or by anyone on the premises with the consent of the Tenant.
25. The Tenant shall indemnify the Landlord for any loss or damage caused by failure to ensure that care is taken to avoid damaging the rented premises by the Tenant or anyone on the premises with the consent of the Tenant. Without limiting the generality of the foregoing, the Tenant shall indemnify the Landlord for the cost of repairs to plumbing blockages caused by the negligence or misuse of the Tenant or invitees.
26. The Tenant shall notify the Landlord or Agent immediately upon becoming aware of any defects in the premises or any other matter which may give rise to a liability pursuant to the Occupier's Liability Act 1983.
27. The Tenant shall not paint or affix any sign or any antenna including Pay TV and Cable TV onto the premises or affix any nail, screw, fastening or adhesive to the interior of the premises without the prior written consent of the Landlord or Agent.
28. The Tenant shall not use the premises for any purpose other than for residential purposes without the written consent of the Landlord.
29. (a) The Tenant shall not keep any animal, bird or pet on the premises without the written consent of the Landlord (Note: written consent of the Body Corporate Committee will be necessary in an own-your-own unit).
(b) If permission has been given for pets to be kept on the property (pets outside at all times) then the tenant shall be responsible to have the premises treated for fleas at the expiration of their tenancy. Damage caused by the pets will be billed to the tenant.
30. The Tenant shall deposit all rubbish including cartons and newspapers in a proper rubbish receptacle with a close fitting lid as required by the Health Department or Local Council. The Tenant is responsible for ensuring that the council waste bins at the property are returned to the property promptly after emptying on collection day and kept in a secure location on all occasions. As a consequence of the above if a bin is lost or stolen due to negligence on part of the tenant, the Tenant will be charged for the replacement bin/s.
31. The Tenant shall comply with any Act, Regulation, rule or direction of any Government, semi Government or statutory body.
32. The Tenant shall allow the Landlord or his Agent to put on the premises a notice or notices 'to let' during the last month of the term of this Agreement. The Tenant shall also allow the Landlord or his Agent to put on the premises a notice or notices 'for sale' or 'auction' at any time during the term of this Agreement and permit access to the premises by the Landlord or his Agent to present the property to prospective purchasers or Tenant upon 24 hours' notice or by Agreement with the Tenant and the Landlord or the Landlord's Agent.
33. (a) The Tenant acknowledges that no promises, representations, warranties or undertakings have been given by the Landlord or Agent in relation to the suitability of the premises for the Tenant purposes or in respect of the furnishing, fittings or accessories of the premises otherwise than as provided herein.
(b) The Tenant agrees they have viewed the property and accepts the condition it is in.
34. No consent or waiver of any breach by the Tenant of the Tenant obligations under the Residential Tenancies Act 1977 shall prevent the Landlord from subsequently enforcing any of the provisions of the Agreement.
35. The Tenant shall at the Tenant expense replace all lighting tubes and globes to the premises which become defective during the term of the tenancy unless the defect is proven to be caused by faulty wiring.
36. The Tenant agrees not to carry out any mechanical repairs or spray painting of any motor vehicles, boats or motor cycles in or around the property including common property. The Tenant also agrees to be fully responsible for the removal of any motor cycle, car or boat spare parts or bodies or any other equipment used and to fully reinstate the premises or the land or common property on which it is situated to their original condition forthwith.
37. The Tenant must:
 - (a) Check each smoke detector in the Premises weekly to confirm that it is kept fully operational. These checks are to ensure the safety of the Tenant and the security of the Premises.
 - (b) Replace the battery in each smoke detector on or about 1 January each year
 - (c) Immediately notify the Landlord/Agent of any faulty smoke detector (and confirm this advice to the Landlord/Agent in writing the same day).
 - (d) Not interfere with the function of the alarm.
38. The Tenant acknowledges that they are responsible to clean the filter on any reverse cycle unit on a regular basis.
BODY CORPORATE
39. The Tenant agrees to observe and be bound by the Articles of Association of the Service Company or the Rules of the Body Corporate (as the case may be) in so far as they relate to or affect the use, occupation and enjoyment of the premises and the common property provided that the Tenant shall not be required to contribute costs of a capital nature or which would, except for the provision, be payable by the Landlord. The Standard Rules of the Subdivision (Body Corporate) Regulations, if not amended, apply to all Bodies Corporate.
40. The Tenant shall not do or allow to be done anything that will cause the shared service facilities to become obstructed, untidy, damaged or used for any purpose other than for which they are intended.
41. This Agreement may be amended only by an Agreement in writing signed by the Landlord and the Tenant.

I acknowledge that I have read and fully understand and agree to all of the above. Initial: Tenant 1 K.H. Tenant 2

Schedule

Item 1: DATE OF AGREEMENT:

Item 2: LANDLORD/S: Name: KAIN - Mr Say Kaing
Address: C/- Gordon Agencies 671 Koorlong Ave Irymple.

Item 3: AGENT: Registered Business Name: GORDON AGENCIES
ABN: 84 100 629 650
Address: 671 Koorlong Avenue, IRYMPLE
Telephone: 50 246855 Facsimile: 50245855

Item 4: TENANT: (1) Name: Keith Michael Harper
Address: 21 William Street, Ouyen 2490

(2) Name:
Address:

Item 5: PREMISES: 21 William Street, OUYEN CODE:413B

Item 6: RENTAL: \$350.00 per week payable fortnightly and 2 Weeks in advance

Item 7: COMMENCING ON: 18/11/2017
Per fortnight ER

Item 8: RENTAL PAYMENTS TO AGENT AT: 671 Koorlong Avenue, IRYMPLE VIC 3496

Item 9: BOND: \$758.00 Paid to landlord/Agent on 14/11/2017

Where there is more than one tenant the amounts they each contribute are listed here:

Name: _____ Amount _____ Name: _____ Amount _____

Name: _____ Amount _____ Name: _____ Amount _____

Item 10: URGENT REPAIRS: The Landlord Authorises the Agent to undertake urgent repairs
\$1,000.00 For urgent repairs PH. 50246855 / After Hours 50 246855

*FIXED TERM AGREEMENT

Item 11: TERM: 12 months

Item 12: COMMENCEMENT DATE: 18/11/2017

Item 13: TERMINATION DATE: 17/11/2018

*PERIODICAL TENANCY

Item 14: COMMENCEMENT DATE: / /

Signed by the Landlord GORDON AGENCIES, IRYMPLE- FOR & ON BEHALF OF: KAIN - Mr Say Kaing
in the presence of:

K. Ralph

(Landlord/Agent)

[Signature]

(Witness)

Signed by the Tenant
in the presence of:

Keith Harper, 15/11/2017

(Tenant/s)

[Signature]

(Witness)

The TENANT hereby acknowledges having received a copy of a Statement of Rights and Duties, two copies of the Conditions Report and a copy of this Tenancy Agreement in accordance with the provisions of the Residential Tenancies Act 1997.

Signed *Keith Harper* _____ (Tenant/s)

Schedule

Item 1: DATE OF AGREEMENT:

Item 2: LANDLORD/S: Name: KAIN - Mr Say Kaing
Address: C/- Gordon Agencies 671 Koorlong Ave Irymple.

Item 3: AGENT: Registered Business Name: **GORDON AGENCIES**
ABN: 84 100 629 650
Address: 671 Koorlong Avenue, IRYMPLE
Telephone: 50 246855 Facsimile: 50245855

Item 4: TENANT: (1) Name: Keith Michael Harper
Address: 21 William Street, OUYEN, Vic. 3490
(2) Name:
Address:

Item 5: PREMISES: 21 Willam Street , OUYEN CODE:745

Item 6: RENTAL: \$360.00 per fortnight payable fortnightly and 2 Weeks in advance

Item 7: COMMENCING ON: 12/12/2018

Item 8: RENTAL PAYMENTS TO AGENT AT: 671 Koorlong Avenue, IRYMPLE VIC 3496

Item 9: BOND: \$758.00 Paid to landlord/Agent on 21/11/2018
Where there is more than one tenant the amounts they each contribute are listed here:

Name: _____ Amount _____ Name: _____ Amount _____

Name: _____ Amount _____ Name: _____ Amount _____

Item 10: URGENT REPAIRS: The Landlord Authorises the Agent to undertake urgent repairs
\$1,800.00 For urgent repairs PH. 50246855 / After Hours 50 246855

*FIXED TERM AGREEMENT

Item 11: TERM: 12 months

Item 12: COMMENCEMENT DATE: 12/12/2018

Item 13: TERMINATION DATE: 11/12/2019

*PERIODICAL TENANCY

Item 14: COMMENCEMENT DATE: / /

Signed by the Landlord in the presence of : GORDON AGENCIES, IRYMPLE- FOR & ON BEHALF OF: KAIN - Mr Say Kaing

(Landlord/Agent)

(Witness)

Signed by the Tenant in the presence of: Keith Harper (Tenant/s)

(Witness)

The TENANT hereby acknowledges having received a copy of a Statement of Rights and Duties, two copies of the Conditions Report and a copy of this Tenancy Agreement in accordance with the provisions of the Residential Tenancies Act 1997.

Signed KEITH HARPER (Tenant/s)



Lease Renewal - Schedule

- Item 1: DATE OF AGREEMENT: 15th February, 2020
- Item 2: LANDLORD/S: Name: Vincenzo Auriemma
Address: Gordon Agencies 671 Koorlong Ave Irymple 3498
- Item 3: AGENT: Registered Business Name: Gordon Agencies Irymple
ABN: 84 100 629 650
Address: 671 Koorlong Avenue, Irymple
Telephone: 50 246855 Facsimile: 50245855
- Item 4: TENANT: (1) Name: Keith Harper
Address: 21 William Street, Ouyen
(2) Name:
Address:
- Item 5: PREMISES: 21 William Street, Ouyen CODE: 413
- Item 6: RENTAL: # \$185.00 per week payable fortnightly and kept 2 weeks in advance
- Item 7: COMMENCING ON: 15th February, 2020
- Item 8: RENTAL PAYMENTS TO AGENT AT: 671 Koorlong Avenue, Irymple
- Item 9: BOND: \$758.00 Paid to landlord/Agent on 17th November, 2016
- Item 10: URGENT REPAIRS: The Landlord Authorises the Agent to undertake urgent repairs \$1,800.00
For urgent repairs PH. 03 5024 6855

*FIXED TERM AGREEMENT

- Item 11: TERM: 12 Months
- Item 12: COMMENCEMENT DATE: 15th February, 2020
- Item 13: TERMINATION DATE: 14th February, 2021

*PERIODICAL TENANCY

- Item 14: COMMENCEMENT DATE: / /

Signed by the Landlord/Gordon Agencies FOR & ON BEHALF OF: AURIEMMA

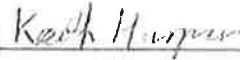

(Landlord/Agent)

Signed by the Tenant 

(Tenant/s)